

## CHAPEL FEATURES

- Sanctuary can accommodate 600 congregants
- Chapel includes seven (7) offices in wing connecting school

## SCHOOL FEATURES

- 15 Classrooms
- Full-service Commercial Kitchen
- Activity Room
- Large Assembly Room with folding partitions creating four (4) enclosed rooms
- Existing onsite Parking for 85 vehicles (200 required by code; adequate land available to meet code requirement)

## AVAILABILITY

PREMISES	16,372 SF Available on 5 Acres
ASKING RATE	Request For Offers to Purchase
TIMING	Immediate
PARKING	85 Parking Spaces (200 required by code; adequate land available to meet code requirement)

**RFOTP and Land Use Regulations are posted on:**  
[www.fort-monmouth-marketing.com](http://www.fort-monmouth-marketing.com)

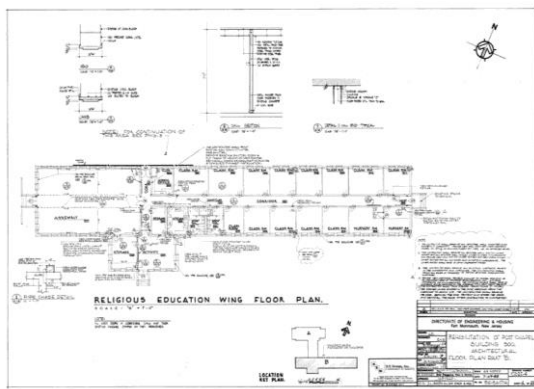
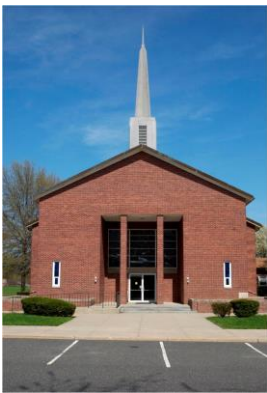

**Additional information on Fort Monmouth can be found at:** [www.fortmonmouthnj.com](http://www.fortmonmouthnj.com)

For more information, please contact:

**LES SMITH**  
 Senior Director  
 (973) 292 4601  
[les.smith@cushwake.com](mailto:les.smith@cushwake.com)

**CHRISTOPHER KINUM**  
 Executive Director  
 (201) 508 5255  
[christopher.kinum@cushwake.com](mailto:christopher.kinum@cushwake.com)

**PAUL GIANNONE**  
 Executive Vice President  
 (732) 452 6184  
[paul.giannone@cushwake.com](mailto:paul.giannone@cushwake.com)

**KEVIN CARTON**  
 Senior Director  
 (732) 452 6186  
[kevin.carton@cushwake.com](mailto:kevin.carton@cushwake.com)

**DAVID BERNHAUT**  
 Vice Chairman  
 (201) 460 3356  
[david.bernhaut@cushwake.com](mailto:david.bernhaut@cushwake.com)

**CUSHMAN & WAKEFIELD  
 OF NEW JERSEY, INC.**  
 Licensed Real Estate Brokers  
 1150 Headquarters Plaza  
 Morristown, NJ 07960  
[www.cushmanwakefield.com](http://www.cushmanwakefield.com)

