

Installation Restoration Program Sites and Environmental Condition of Property Parcels Charles Wood Area Fort Monmouth, New Jersey

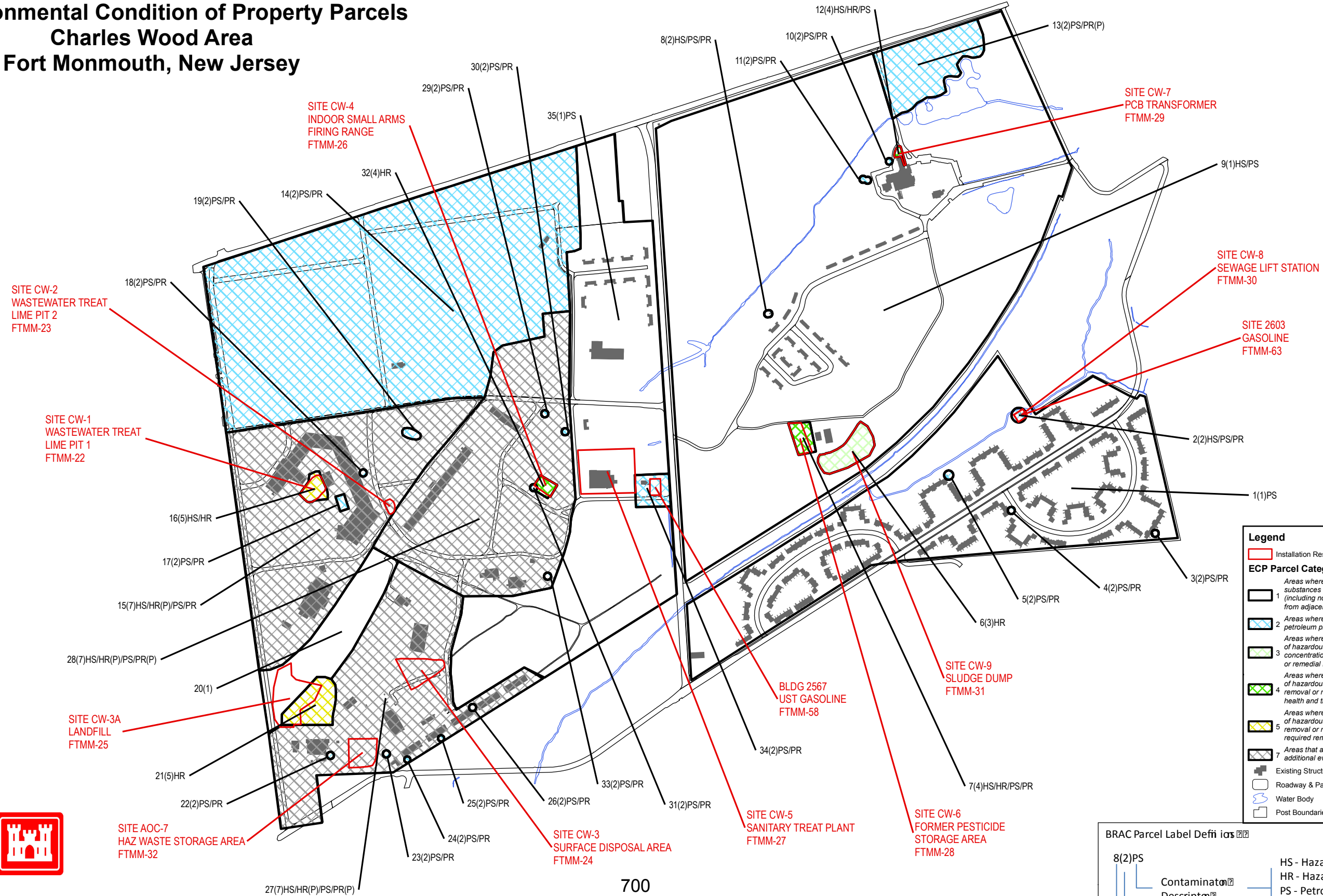
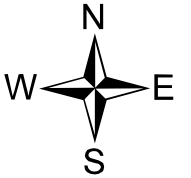

Legend

Installation Restoration Program Site

ECP Parcel Category Definitions

1 Areas where no release or disposal of hazardous substances or petroleum products has occurred (including no migration of these substances from adjacent areas).

2 Areas where only release or disposal of petroleum products has occurred.

3 Areas where release, disposal, and/or migration of hazardous substances has occurred, but at concentrations that do not require a removal or remedial response.

4 Areas where release, disposal, and/or migration of hazardous substances has occurred, and all removal or remedial actions to protect human health and the environment have been taken.

5 Areas where release, disposal, and/or migration of hazardous substances has occurred, and removal or remedial actions are underway, but all required remedial actions have not yet been taken.

6 Areas that are not evaluated or require additional evaluation.

Existing Structure

Roadway & Parking

Water Body

Post Boundaries

BRAC Parcel Label Definitions

8(2)PS
 Contaminant Description
 Category Number
 Parcel Number

HS - Hazardous Substance Storage
 HR - Hazardous Substance Release
 PS - Petroleum Storage
 PR - Petroleum Release
 (P) - Possible Release or Disposal

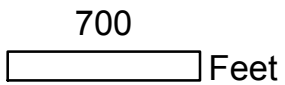

Map Created by:
Fort Monmouth Installation GIO, Environmental Division
Fort Monmouth, New Jersey
Date: June 14, 2010
All drawings must be field verified.
New Jersey State Plane Feet, NAD83

U.S. Army Fort Monmouth IRP and Phase II Sites

<u>IRP Sites</u>
M2 - Landfill
M3 - Landfill
M4 - Landfill
M5 - Landfill
M6 - Burning Area
M7 - Burning Area
M8 - Landfill
M9 - PCB Transformer, B-1150
M10 - Asbestos Storage
M11 - Elevated Water Tank
M12 - Landfill
M-13 Pathogenic Waste Incinerator
M14 - Landfill
M15 - Water Tank
M16 - Pesticide Storage, B-498
M17 - Pesticide Storage BLDG T-65
M18 - Former Training Area/Landfill
M19 - Sanitary Treatment Plant
M20 - Former Sanitary Treatment Plant
M21 - Former Firing Range
M22 - (CW-1) Wastewater Treat Lime Pit
M23 - (CW-2) Wastewater Treat Lime Pit
M24 - (CW-3) Surface Disposal Area
M25 - (CW-3A) Landfill
M26 - Indoor Small Arms Range
M27 - (CW-5) Sanitary Treat Plant
M28 - (CW-6) Former Pesticide Storage
M29 - (CW-7) PCB Transformer
M30 - (CW-8) Sewage Lift Station
M31 - Sludge Dump
M32 - (AOC-7) HAZ Waste Storage
M47 - Former PCB Transformer, B-1002
M53 - BLDG 699, Gasoline Storage
M54 - BLDG 296, Gasoline Storage
M55 - BLDG 290, UST Gasoline
M56 - BLDG 80, Petroleum Release
M57 - BLDG 108 UST Gasoline Release
M58 - BLDG 2567, UST Gasoline

U.S. Army Fort Monmouth IRP and Phase II Sites

M59 - BLDG 1122, Unknown Discharge
M61 - B37BLDG 283, Leaking UST Gasoline
M63 - BLDG 2603 UST Gasoline
M64 - BLDG 812 UST Gasoline
M66 - BLDG 886 Former AST
ECP PHASE Parcels
Parcel #1 - Pinebrook Housing
Parcel #2 - M63, Sewage Lift Station
Parcel #3 - Former UST
Parcel #4 - Former UST
Parcel #5 - Former UST
Parcel #6 - Fomer sludge Disposal, M31
Parcel #7 - Former Pesticide Storage
Parcel #8 - Former UST
Parcel #9 - Pesticide Mixing Area
Parcel #10 - Former UST
Parcel #11 - Former UST
Parcel #12 - Former PCB Transformer location
Parcel #13 - Former UST
Parcel #14 - Former AFH, Northwest of CWA
Parcel #15 - CW 2 and Former Barracks
Parcel #16 - Former Wasitewater Treatment Pit, CW1
Parcel #17 - Former UST
Parcel #18 - Former UST
Parcel #19 - Former UST
Parcel #20 - Undisturbed area along SW portion of Parker Creek
Parcel #21 - M25, Suspected former Landfill
Parcel #22 - Former UST
Parcel #23 - Former UST
Parcel #24 - Former UST
Parcel #25 - Former UST
Parcel #26 - Former UST
Parcel #27 - Southwest Corner of CWA
Parcel #28 - Former lab and Motor Pool
Parcel #29 - Former UST
Parcel #30 - Former UST
Parcel #31 - Former UST
Parcel #32 - Former Small Arms Range

U.S. Army Fort Monmouth IRP and Phase II Sites

Parcel #33 - Former UST
Parcel #34 - M58, Bldg 2567
Parcel #35 - Child Development Center, Residential Housing
Parcel #36 - Southwest corner of Main Post
Parcel #37 - Bldg 1220, Boiler Plant
Parcel #38 - Former Outdoor Firing Range
Parcel #39 - Bldg 1150 Film Developing Activities
Parcel #40 - M2, Landfill
Parcel #41 - M59
Parcel #42 - Former UST, Bldg 1122
Parcel #43 - Bldg 1122 Former Waste Handling Activities
Parcel #44 - Former Skeet Range
Parcel #45 - Former USTs
Parcel #46 - Former Incinerator, M7
Parcel #47 - Former Pistol Range, M19
Parcel #48 - Former Training Area, M18
Parcel #49 - Former Lab and Battery Test Facility
Parcel #50 - Former Fuel Distribution Facility
Parcel #51 - Motor Pool, Administrative, Barracks, Former USTs
Parcel #52 - M53, Bldg 699 Gas Station
Parcel #53 - Former Housing, 700 Area
Parcel #54 - 700 and 800 Areas
Parcel #55 - Former Motor Pool, Vet Lab, Bldg 876
Parcel #56 - 800 Area RCI Project, Former Housing
Parcel #57 - Former Coal Storage and RR unloading area
Parcel #58 - Former USTs
Parcel #59 - Former UST
Parcel #60 - Bldg 1077, 1078, Residential Housing
Parcel #61 - Bldg 1075 Former Medical Discharge
Parcel #62 - M13, Former Pathogenic Waste Incinerator
Parcel #63 - Former UST
Parcel #64 - Former gas distribution area
Parcel #65 - B886, M66, Former AST
Parcel #66 - 900 Area, Electrical Substation
Parcel #67 - Former UST
Parcel #68 - Former UST
Parcel #69 - Bldg 900 Former Motor Pool
Parcel #70 - Bldg 551 former Photoprocessing
Parcel #71 - M12, M14 Landfill

U.S. Army Fort Monmouth IRP and Phase II Sites

Parcel #72 - 200 and 300 Areas
Parcel #73 - Former UST
Parcel #74 - Former UST
Parcel #75 - M20, Sewage Treatment Plant
Parcel #76 - Former Barracks
Parcel #77 - Former UST
Parcel #78 - M15, elevated Water Tank
Parcel #79 - Potential Former USTs
Parcel #80 - Former Photoprocessing, Bldgs 105 and 106
Parcel #81 - M16, Former Pesticide Storage Area
Parcel #82 - 400 Area
Parcel #83 - Former Industrial and Vehicle Related Activities
Parcel #84 - M56, Former UST
Parcel #85 - Former UST
Parcel #86 - Former UST
Parcel #87 - Former USTs
Parcel #88 - M17, Former Pesticide Storage Area
Parcel #89 - Former USTs
Parcel #90 - Former UST
Parcel #91 - Former UST
Parcel #92 - Former UST
Parcel #93 - Former UST
Parcel #94 - Former UST
Parcel #95 - PCB Transformer leak
Sanitary Sewer System
Electrical Substation