



FORT MONMOUTH ECONOMIC REVITALIZATION AUTHORITY

**REQUEST FOR OFFERS TO PURCHASE**

**FOR**

**THE SALE OF REAL PROPERTY**

**Fort Monmouth Child Development Center/Building 2290**

Issued by the  
**FORT MONMOUTH ECONOMIC REVITALIZATION AUTHORITY**

Date Issued: February 27, 2015

**Responses due by 12:00 P.M. EDT on April 27, 2015**

# REQUEST FOR OFFERS TO PURCHASE FOR THE SALE OF REAL PROPERTY

## SUMMARY

The Fort Monmouth Economic Revitalization Authority (“FMERA” or the “Authority”), a state authority created pursuant to P.L. 2010, c.10 (N.J.S.A. 52:27I-18 et seq.), is responsible for the orderly and comprehensive redevelopment of Fort Monmouth. In furtherance of its mission, FMERA is hereby seeking offers to purchase Authority-owned property from individuals or entities. This request for offers to purchase (“RFOTP”) is being issued under FMERA’s rules for the sale of real and personal property (N.J.A.C. 19:31C-2, the “Sales Rules”). The successful Potential Purchaser as defined below shall be subject to the terms and provisions of the Sales Rules and the Phase 1 Economic Development Conveyance Agreement (“EDC Agreement”) between FMERA and the Army. Redevelopment of the property will be subject to the Fort Monmouth Reuse and Redevelopment Plan (the “Reuse Plan”), which operates as the de facto master plan for Fort Monmouth, and FMERA’s land use regulations and design and development guidelines (N.J.A.C. 19:31C-3, the “Land Use Rules”), which serve as the zoning ordinance for the Fort. The Reuse Plan and the Land Use Rules supersede the master plan, the zoning and land use ordinance and regulations, and the zoning map of the Borough of Tinton Falls and Monmouth County development regulations, except for procedures for site plan and subdivision approval.

### 1.0 PURPOSE

The Authority is requesting offers to purchase (the “Offer”) from qualified individuals or entities (“Potential Purchaser(s)”) interested in purchasing a 7.4 acre parcel of land bordering Hope Road to the east and Corregidor Road to the south containing Building 2290, a 19,600sf building constructed in 1996. The facility formerly housed a Child Development/Daycare Center and is fitted out with age appropriate sinks and toilets. The building contains classrooms and a kitchen facility.

A map of the Property and a floor plan for Building 2290 can be found in ATTACHMENT #1 of this RFOTP.

In addition to a price proposal, the Offers must include a plan for the redevelopment of the Property, either for a use consistent with the Reuse Plan and the Land Use Rules, or for another commercial use.

The property will be sold “As Is – Where Is”. The property is located in the Hemphill Neighborhood. The permitted uses include institutional; civic; and open space/recreational. The Reuse Plan contemplates reuse of the building as a child care/school facility. FMERA will review Offers that propose uses for the Property that are inconsistent with the Reuse Plan, but FMERA will be under no obligation to accept any such Offer. A proposed development that is determined by FMERA to be inconsistent with the Reuse Plan would require the adoption of

either a Reuse Plan amendment or a “use-type” variance prior to approval of the application for development. Approval of a Reuse Plan amendment or a “use-type” variance would be at the sole discretion of the FMERA Board.



*Building 2290, the Fort Monmouth Child Development Center*

## 1.1 THE PROPERTY

The Army issued an environmental clearance document, known as a Finding of Suitability to Transfer (“FOST”), covering the Property in August 2013. Per the FOST, there are no known environmental issues affecting the Property. The FOST is available at:

[http://www.pica.army.mil/FtMonmouth/Documents/2013%2008%2012%20FTMM%20finalFOS T%20P1\\_red.pdf](http://www.pica.army.mil/FtMonmouth/Documents/2013%2008%2012%20FTMM%20finalFOS T%20P1_red.pdf).

Pursuant to the Comprehensive Environmental Response, Compensation, and Liability Act (CERCLA), the Army will retain responsibility for any environmental contamination (other than asbestos, lead-based paint and commercially-applied pesticides and termiticides) that may be present on the Property as of the date of closing with FMERA. The selected Potential Purchaser will be afforded the opportunity to perform due diligence investigations prior to closing at its sole cost and expense.

Bidders are hereby notified that registered pesticides may have been applied to the Property and may continue to be present. The Army has advised FMERA that where a pesticide was applied it was applied in accordance with its intended purpose and consistently with the Federal Insecticide, Fungicide, and Rodenticide Act (FIRA), 7 U.S.C. § 136, et seq., and other applicable laws and regulations. If the successful bidder takes any action with regard to the Property, including demolition of structures or any disturbance or removal of soil that may expose, or

cause a release of, a threatened release of, or an exposure to, any such pesticide, it would assume all responsibility and liability therefore.

FMERA received title to the Property from the Army via quitclaim deed in June 2014 and will transfer title to the selected Potential Purchaser by quitclaim deed. The Property will be sold in “as is-where is” condition.

To facilitate the redevelopment process, the Borough of Tinton Falls has designated the Property as an Area in Need of Redevelopment.

## **1.2 PERSONAL PROPERTY**

Consistent with federal Base Realignment and Closure (“BRAC”) law, FMERA intends to include the remaining furniture, fixtures and equipment located within the building on the Property with the sale of the building. Any such furniture, fixtures or equipment will be conveyed in “as-is where-is” condition. Furthermore, FMERA makes no representations as to the compatibility of the remaining furniture, fixture and equipment with state or federal child care or educational standards.

## **1.3 FORT MONMOUTH’S REDEVELOPMENT STATUS**

Fort Monmouth consists of 1,127 acres located in the Boroughs of Tinton Falls, Eatontown and Oceanport, New Jersey. Established in 1917 as Camp Little Silver, the Fort served as the home of the Signal Corps, and later CECOM, the Communications and Electronics Command. The Fort was designated for closure in the 2005 BRAC round, and formally closed in September 2011. FMERA entered into the EDC Agreement with the Army in June 2012, and took title to an initial property, a 55-acre tract in Tinton Falls known as Parcel E, in January 2013. FMERA subsequently sold Parcel E to CommVault, one of the nation’s leading data and information management software companies, for construction of a new headquarters complex for the company. CommVault occupied the first building in the complex, a 275,000 sf facility for 900 employees, in late 2014. The company has approvals in hand to develop up to 650,000 sf for an estimated 2,500 employees.



*CommVault's new Headquarters located across Guam Lane from Building 2290*

FMERA acquired the former Patterson Hospital from the Army and sold it to AcuteCare Health System in March 2014. AcuteCare is renovating the 100,000 sf building for use as an outpatient health clinic. The facility is scheduled to open in the 1<sup>st</sup> Quarter of 2015.



*Rendering of AcuteCare's renovated facility*

FMERA is currently in negotiations with developers for the sale of seven other parcels, four of which are located in the Tinton Falls section of the Fort. Another fifteen parcels, ranging from individual buildings to large land tracts, will be released for proposals within the next six months.

At full buildout in approximately twelve years, the Fort is projected to include:

- 1,585 housing units, with over 4,000 new residents
- 300,000 sf of non-profit, civic, government and educational uses
- 500,000 sf of retail space
- 2,000,000 sf of office, research & development and other commercial uses

Total development costs are estimated at \$1.5 billion, generating 10,000 permanent jobs.

Fort amenities are anticipated to include:

- preservation of approximately 40% of the Fort's land area as recreational and passive open space
- creation of a system of bicycle lanes, pedestrian paths and/or multi-purpose trails
- dedication of an interconnected blue/green belt spanning the Fort
- a shuttle system linking the Fort with mass transit, including the Little Silver train station
- improved access to the Garden State Parkway via a new interchange (Exit 105A)

In addition to the above amenities, the Fort plans to also be home to a renovated fitness center, bowling alley, performing art center/theater, golf course and marina.

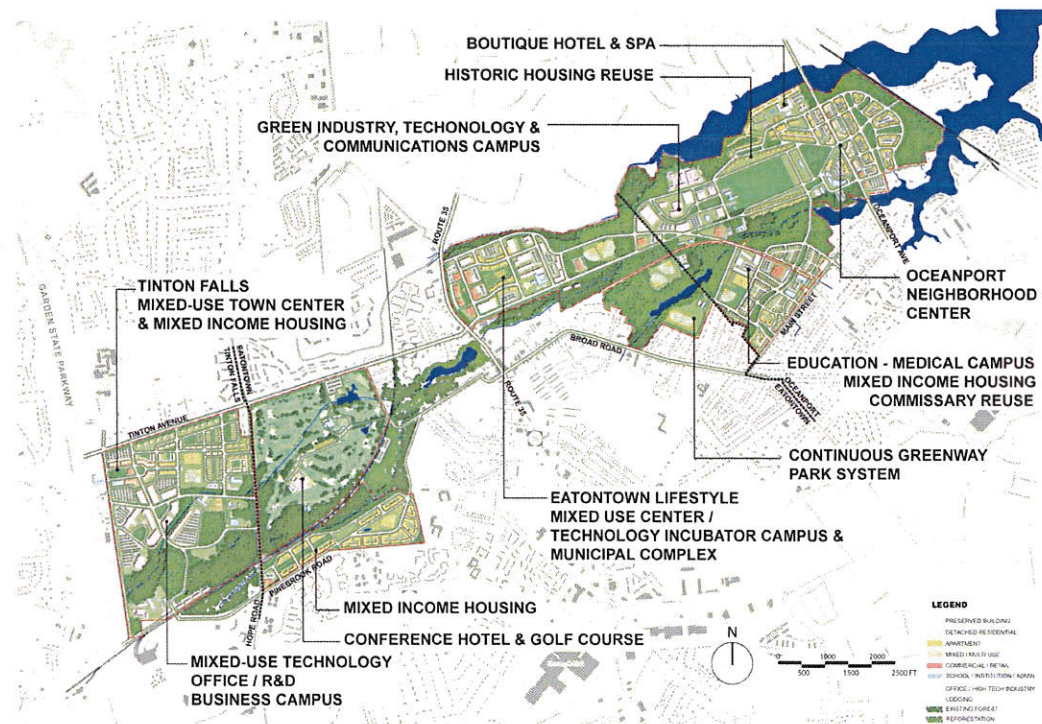

***Fort Monmouth's 20-year Concept Plan***

## **1.4 UTILITIES**

When the Fort was active, the Army provided utility service via government-owned systems. In the 1990s, the Army entered into an agreement with New Jersey Natural Gas to install gas mains on the Fort, including the streets abutting the Property. FMERA recently installed new and/or upgraded trunk infrastructure within the future public rights of way abutting the Property. New 24" DIP water mains have been installed in Corregidor Road and Pearl Harbor Avenue, and a new SDR 35 sanitary sewer main has been installed in Corregidor Road. Water service will be provided by New Jersey American Water Company, and sewer service will be provided by the Borough of Tinton Falls. These upgraded utilities are sized to accommodate the existing and contemplated improvements called out in the Reuse Plan.

The selected Potential Purchaser will be responsible for making any needed improvements or upgrades to utility infrastructure within the footprint of the Property. While the sanitary sewer and water lines are new and connected to the building, FMERA anticipates that the selected Potential Purchaser, at its sole cost and expense, will be required to have a new electrical service installed by Jersey Central Power and Light Company (JCP&L). Potential Purchasers proposing developments that are inconsistent with the Reuse Plan may also be expected to contribute toward off-site improvements to the extent required by their proposed development.

## **1.5 INFRASTRUCTURE DISTRICT; SALES TAXES**

The state statute creating FMERA, P.L. 2010, c.10 (N.J.S.A. 52:27I-18 et seq.), allows FMERA to create infrastructure districts to support the redevelopment of the Fort. Retail sales within the districts will be exempt to the extent of 50% of the retail sales taxes (except taxes generated from the retail sale of motor vehicles, alcoholic beverages, cigarettes or energy) normally collected by the State of New Jersey, and FMERA may collect a franchise assessment not to exceed the remaining 50% of retail sales taxes normally collected, to be used by FMERA toward on-site or off-site infrastructure improvements, or parking or transportation facilities, or work that reduces, abates, or prevents environmental pollution, or other improvements that provide a public benefit within or to an infrastructure district. FMERA may, at its Board's discretion, opt to collect less than 50% of normal sales taxes through the franchise assessment, effectively allowing retailers to charge less than the 7% sales tax imposed under the New Jersey Sales and Use Tax Act.

The Purchase and Sale & Redevelopment Agreement between FMERA and the Prospective Purchaser will require that, in the event FMERA creates an infrastructure district that includes the Property within its boundaries, the Potential Purchaser and any tenants operating a retail business on the Property will apply to be a certified retail vendor.

## **2.0 PREVAILING WAGE REQUIREMENT**

The Potential Purchaser shall comply with the Prevailing Wage requirements set forth in N.J.S.A. 52:27I-31 (P.L. 2010, c. 51). This requirement pertains to all demolition, utility, infrastructure, site preparation and vertical construction proposed on the Property as part of the approved project. Prospective Purchasers should take Prevailing Wage requirements into account in formulating Offers.

## 2.1 ADDITIONAL TERMS OF SALE

Pursuant to FMERA's Land Use Rules, all purchasers of real estate on Fort Monmouth must enter into a redevelopment agreement, which FMERA addresses through a combined purchase and sale & redevelopment agreement (PSARA). The PSARA will contain the following provisions, which will be covenants running with the land until the redeveloper completes the project:

- i. A provision limiting the use of the Property (and the Optional Property, if applicable) to the uses permitted by the Reuse Plan or an amendment to the Reuse Plan as approved by the FMERA Board and uses permitted by the Land Use Rules;
- ii. A provision requiring the redeveloper to commence and complete the project within a period of time that FMERA deems reasonable; and
- iii. A provision restricting transfer of the Property (and the Optional Property, if applicable) or the redeveloper's rights under the PSARA prior to completion of the project.

The PSARA will require the redeveloper to guaranty its project commencement and completion and job creation obligations by posting bonds or providing other assurances or penalties. See Section 6(h) below for additional information regarding job creation requirements.

## 3.0 PUBLIC INSPECTION OF DOCUMENTS

Due diligence material and documents held by FMERA pertaining to the Property and/or building(s) will be made available for the review and inspection by Potential Purchaser(s) during normal business hours at the FMERA office located at Fort Monmouth, New Jersey. Interested Potential Purchasers may make copies of the paper documents. Please note: FMERA does not warrant the accuracy or completeness of any documents originated by the Army or other sources. Copies of any documents requested that are larger than legal size shall be made at the expense of the Potential Purchaser. A copy of digital files will also be available upon request without charge. Limited materials and documents will be available for review and inspection during the tour referred to in Section 4.0 below.

Materials made available by FMERA for public inspection are offered "as is" and "where is" and they may include pertinent information regarding building plans, the environmental conditions, utility access, and other information related to these facilities. However, FMERA shall not be held responsible or liable for the accuracy or inaccuracy of such information or materials reviewed or obtained. All Potential Purchaser(s) shall be wholly responsible for their own due diligence efforts. Any information obtained by the Potential Purchaser(s) shall become the property of the Authority immediately upon the Potential Purchaser's submission of its offer and the release of such information by the Potential Purchaser to a third party shall only be made with the written approval of the Authority.



#### 4.0 TOURS

Walk-through tours will commence on March 4, 2015 at 10:00 A.M. The last day to request a walk through tour of the Property is April 20, 2015. Please schedule a walk-through tour by contacting Regina McGrade at [rmcgrade@njedac.com](mailto:rmcgrade@njedac.com) or 732-720-6350.

#### 5.0 OFFER SUBMISSION

**Five (5) copies** of the Offer (one (1) unbound, original; three (3) bound copies and one (1) copy in PDF format on a CD) must be submitted marked "REQUEST FOR OFFERS TO PURCHASE FOR THE SALE OF REAL AND PERSONAL PROPERTY" in a sealed package and addressed to:

Bruce Steadman  
Executive Director  
Fort Monmouth Economic Revitalization Authority

**Offers must be received by April 27, 2015 at 12:00 P.M. Eastern Daylight Time (EDT).**

**Proposals must be received by April 27, 2015 at 12:00 P.M., EDT. Proposals may be delivered via an overnight service (FedEx or UPS) to 100 Barton Avenue, Oceanport, NJ 07757.**

**Hand delivered proposals must be received at the FMERA Offices located at 502 Brewer Avenue, within the former Fort Monmouth Army Post by April 27, 2015 at 12:00 P.M. EDT. Access to the FMERA Staff Office is via the Fort Monmouth Main Gate located on the west side of Oceanport Avenue, Oceanport, NJ.**

**For USPS mail delivery, please mail to FMERA, P.O. Box 267, Oceanport, NJ 07757. All USPS mail deliveries must be received by April 27, 2015 at 12:00 P.M. EDT.**

**No faxed or email offers will be accepted. Offers received after the time and date listed above will not be accepted.**

**Proposals will be publically opened on April 27, 2015 at 12:30 P.M. at the Authority Offices located at 502 Brewer Avenue, on the former Fort Monmouth Army Post.**

The Authority will not be responsible for any expenses in the preparation and/or presentation of the Offers or for the disclosure of any information or material received in connection with this solicitation, whether by negligence or otherwise.

The Authority reserves the right to request additional information if necessary, or to reject any and all Offers with or without cause, and, in its sole discretion, waive any irregularities or informalities, such as minor elements of non-compliance with regard to the requirements of this RFOTF, in the Offers submitted. The Authority further reserves the right to make such investigations as it deems necessary as to the qualifications of any and all firms submitting

Offers. In the event that all Offers are rejected, the Authority reserves the right to re-solicit Offers.

The Authority also may seek to obtain business terms that better suit the interests of the Authority and the redevelopment plans for Fort Monmouth, price and other factors considered, by negotiating with the Potential Purchaser(s) that submit the best Offer(s) in accordance with the evaluation criteria set forth in this RFOTP. The Authority reserves the right to exclude from negotiations any and/or all Offers received based on the initial submissions. Negotiations with a Potential Purchaser will not preclude the Authority from negotiating with other Potential Purchasers unless the Authority has entered into an exclusive negotiating period with a Potential Purchaser in accordance with rule N.J.A.C. 19:31C-2.16.

Responding Potential Purchasers may withdraw their Offers at any time prior to the final filing date and time, as indicated on the cover page to this RFOTP, by written notification signed by an authorized agent of the firm(s). Offers may thereafter be resubmitted, but only up to the final filing date and time.

The responding Potential Purchaser assumes sole responsibility for the complete effort required in this RFOTP. No special consideration shall be given after the Offers are opened because of a Potential Purchaser's failure to be knowledgeable about all requirements of this RFOTP. By submitting an Offer in response to this RFOTP, the Potential Purchaser represents that it has satisfied itself, from its own investigation, of all of the requirements of this RFOTP.

By submitting an Offer in response to this RFOTP, each Potential Purchaser agrees to hold its Offer open for at least ninety (90) days after the response due date. Any provision in a submitted Offer that attempts to limit or condition the time that an Offer is open for consideration by FMERA will not be binding on FMERA. FMERA reserves the right, upon good cause shown to the satisfaction of FMERA's staff, to allow a Potential Purchaser to withdraw its Offer after Offers have been opened.

Documents and information submitted in response to this RFOTP shall become property of the Authority and generally shall be available to the general public as required by applicable law, including the New Jersey Open Public Meetings Act, N.J.S.A. 10:4-1 et seq., the New Jersey Open Public Records Act, N.J.S.A. 47:1A-1 et seq. and New Jersey right-to-know laws.

Communications with representatives of the Authority by the Potential Purchaser or the Potential Purchaser's representatives concerning this RFOTP are **NOT** permitted during the term of the submission and evaluation process. Communications regarding this RFOTP in any manner (except as set forth in Section 4 above and Section 7 below or negotiations initiated by the Authority) **will result in the immediate rejection** of the Potential Purchaser's Offer.

## 6.0 OFFER REQUIREMENTS

In order to be considered, all offers to purchase from the Authority must include the following:

- a. **Cover Letter.** A letter identifying the Offer and disclosing the documentation included. The Potential Purchaser must indicate the name and contact information for

the individual who will be its senior contract person for its Offer. The Potential Purchaser must also indicate whether the firm is operating as an individual proprietorship, partnership, corporation, a joint venture or a governmental entity. The cover letter should also indicate the state of incorporation of the Potential Purchaser.

- b. **Price Submittal.** A signed document stating the proposed purchase price. Identify any closing contingencies and specify the time period required to complete due diligence and satisfy any closing contingencies. If the development plan envisions demolition of some or all of the existing buildings, the Offer must include an estimate of demolition costs and state whether the proposed purchase price is net of demolition costs.
- c. **Offer Deposit.** A payment of five (5%) percent of the purchase price offered by the Potential Purchaser which shall be held in an interest bearing account as an initial deposit and applied to the purchase for the accepted Offer, and returned to all others. An additional deposit of ten (10%) percent of the offer price shall be payable to the Authority on the earlier of:
  - i. FMERA and the potential purchaser entering into an exclusive negotiating period in accordance with N.J.A.C. 19:31C-2.16; or
  - ii. a purchase agreement with FMERA being fully negotiated and signed by the purchaser. The initial deposit and the additional deposit shall be applied to the purchase price at closing.

The deposit shall be in the form of a certified, cashier's or bank check made payable to the Authority issued by a FDIC accredited financial institution.

The deposit may also be a wire transfer of immediately available funds. Please contact Regina McGrade at [rmcgrade@njeda.com](mailto:rmcgrade@njeda.com) or 732-720-6350 for wiring instructions.

- d. **Conceptual Redevelopment Plan.** A conceptual plan for the redevelopment of the Property, including an elevation sketch, showing the general site or other improvements, if any, at the Property as well as their estimated costs.
- e. **Financing Plan.** State your proposed capital investment and list your financial(s) and committed resources evidencing the Potential Purchaser's financial ability to meet the financial requirements of the Potential Purchaser's development plan.
- f. **Schedule of Critical Paths.** A detailed summary of construction schedules, time to complete purchase and estimated leasing and/or resale timeframe if applicable. Please note that FMERA's Land Use Rules contain a procedural section that outlines the site plan application and approval process.
- g. **Management & Organizational Plan.** A detailed summary of management and experience, organizational chart, as well as total number of other projects of similar size completed by the Potential Purchaser.

- h. **Jobs Generation.** Provide an estimated number of construction jobs and permanent jobs (specifying those new to New Jersey vs. those retained within the state) to be created at the Property. Purchaser will be held to a minimum jobs creation number based on this estimate which will be a condition of the Purchase and Sale and Redevelopment Agreement with the successful purchaser.
- i. **Prevailing Wage Obligation.** As part of its Offer, the Potential Purchaser should state its acceptance of FMERA’s prevailing wage requirements set forth in Section 2.0 above and articulate its planned approach to meeting these requirements.
- j. **Disclosure of Investment Activities in Iran.** A completed and signed Disclosure of Investment Activities in Iran form.

## 7.0 QUESTIONS AND ANSWERS

The Authority will also accept questions from firms regarding any aspect of this RFOTP via e-mail only until 5:00 p.m. Eastern Standard Time on April 20, 2015. Questions should be directed via e-mail to:

[rharrison@njeda.com](mailto:rharrison@njeda.com)

All answers to questions posed will be posted on the Authority website at [www.fortmonmouthredevelopment.com](http://www.fortmonmouthredevelopment.com) and/or through an addendum (if any) to this RFOTP made available to all potential bidders at the Authority website.

## 8.0 COMPLIANCE WITH STATE LAW REQUIREMENTS

### 8.1 Chapter 51, Executive Order No. 117 And Executive Order No. 7

In order to safeguard the integrity of State government, including the Authority, procurement by imposing restrictions to insulate the negotiation and award of State and Authority contracts from political contributions that pose the risk of improper influence, purchase of access, or the appearance thereof, the Legislature enacted P.L. 2005, c. 51 (codified at N.J.S.A. 19:44A-20.13 – 25)(“Chapter 51”), on March 22, 2005, effective retroactive October 15, 2004, superseding the terms of Executive Order No. 134. In addition, on September 24, 2008, Governor Corzine issued Executive Order No. 117, effective on November 15, 2008 (“EO 117”) setting forth additional limitations on the ability of Executive Branch agencies to contract with consultants who have made or solicited certain contributions. Governor Christie issued Executive Order No. 7 on January 20, 2010 (“EO 7”), and effective the same day, setting forth additional limitations on the ability of Executive Branch agencies to contract with consultants who have made or solicited certain contributions. Pursuant to the requirements of Chapter 51, EO 117, and EO 7 the terms and conditions set forth in this section are material terms of this engagement:

## **I. Definitions:**

For the purpose of this section, the following shall be defined as follows:

(a) Contribution means a contribution reportable as a recipient under The New Jersey Campaign Contributions and Expenditures Reporting Act, P.L. 1973, c. 83 (C.19:44A-1 et seq.), and implementing regulations set forth at N.J.A.C. 19:25-7 and N.J.A.C. 19:25-10.1 et seq. Contributions in excess of \$300 during a reporting period are deemed "reportable" under these laws.

(b) Business Entity means any natural or legal person, business corporation, professional services corporation, Limited Liability Company, partnership, limited partnership, business trust, association or any other legal commercial entity organized under the laws of New Jersey or any other state or foreign jurisdiction. The definition of a business entity includes:

(i) All principals who own or control more than 10 percent of the profits or assets of a business entity or 10 percent of the stock in the case of a business entity that is a corporation for profit, as appropriate and for a for profit entity, the following:

(1) In the case of a corporation: the corporation, any officer of the corporation, and any Person or business entity that owns or controls 10% or more of the stock of the corporation;

(2) In the case of a general partnership: the partnership and any partner;

(3) In the case of a limited partnership: the limited partnership and any partner;

(4) In the case of a professional corporation: the professional corporation and any shareholder or officer;

(5) In the case of a limited liability company: the limited liability company and any member;

(6) In the case of a limited liability partnership: the limited liability partnership and any partner;

(7) In the case of a sole proprietorship: the proprietor; and

(8) In the case of any other form of entity organized under the laws of this State or any other state or foreign jurisdiction: the entity and any principal, officer, or partner thereof;

(ii) Any subsidiaries directly or indirectly controlled by the business entity;

(iii) Any political organization organized under section 527 of the Internal Revenue Code that is directly or indirectly controlled by the business entity, other than a candidate committee, election fund, or political party committee; and

(iv) If a business entity is a natural person, that person's spouse or civil union partner, or child residing in the same household provided, however, that, unless a contribution made by such spouse, civil union partner, or child is to a candidate for whom the contributor is entitled to vote or to a political party committee within whose jurisdiction the contributor resides unless such contribution is in violation of section 9 of Chapter 51.

(v) Any labor union, labor organization, and any political committee formed by a labor union or labor organization if one of the purposes of the political committee is to make political contributions.

## **II. Breach of Terms of Chapter 51, EO 117 and EO 7 is a breach of this engagement:**

It shall be a breach of the terms of this engagement for the Business Entity to do any of the following:

(a) Make or solicit a contribution in violation of the Chapter 51, EO 117 and EO 7;

(b) Knowingly conceal or misrepresent a contribution given or received;

(c) Make or solicit contributions through intermediaries for the purpose of concealing or misrepresenting the source of the contribution;

(d) Make or solicit any contribution on the condition or with the agreement that it will be contributed to a campaign committee or any candidate of holder of the public office of Governor, or of Lieutenant Governor, or to any State, county or municipal party committee, or any legislative leadership committee;

(e) Engage or employ a lobbyist or consultant with the intent or understanding that such lobbyist or consultant would make or solicit any contribution, which if made or solicited by the business entity itself, would subject that entity to the restrictions of Chapter 51, EO 117 and EO 7;

(f) Fund contributions made by third parties, including consultants, attorneys, family members, and employees;

(g) Engage in any exchange of contributions to circumvent the intent of the Chapter 51, EO 117 or EO 7; or

(h) Directly or indirectly through or by any other person or means, do any act which would subject that entity to the restrictions of the Chapter 51, EO 117 and EO 7.

## **III. Certification and disclosure requirements:**

(a) The State or the Authority shall not enter into a contract to procure from any Business Entity services or any material, supplies or equipment, or to acquire, sell or lease any land or building, where the value of the transaction exceeds \$17,500, if that Business Entity has solicited or made any contribution of money, or pledge of contribution, including in-kind contributions to a

candidate committee and/or election fund of any candidate for or holder of the public office of Governor or Lieutenant Governor, or to any State, county political party, or to a legislative leadership or municipal political party, committee during certain specified time periods.

(b) Prior to entering any contract with any Business Entity, the Business Entity proposed as the Potential Purchaser under the contract shall submit the Certification and Disclosure form, certifying that no contributions prohibited by Chapter 51 have been solicited or made by the Business Entity and reporting all contributions the Business Entity made during the preceding four years to any political organization organized under 26 U.S.C. 527 of the Internal Revenue Code that also meets the definition of a continuing political committee within the mean of N.J.S.A. 19:44A-3(n) and N.J.A.C. 19:25-1.7. The required form and instructions for completion and submission to the Authority at the time of submission of an offer in response to the RFOTF are available for review on the Purchase Bureau website at:

<http://www.state.nj.us/treasury/purchase/forms.htm#eo134>.

(c) Further, the Potential Purchaser is required, on a continuing basis, to report any contributions and solicitations Potential Purchaser makes during the term of the contract, and any extension(s) thereof, at the time any such contribution or solicitation is made.

(d) Potential Purchaser's failure to submit the required forms will prevent FMERA from entering into a Purchase and Sale & Redevelopment Agreement with the Potential Purchaser. The State Treasurer or his designee shall review the Disclosures submitted by the Potential Purchaser pursuant to this section, as well as any other pertinent information concerning the contributions or reports thereof by the intended Potential Purchaser, prior to award, or during the term of the retention agreement. If the State Treasurer determines that any contribution or action by the Potential Purchaser violated Chapter 51 or EO 117 the State Treasurer shall disqualify the Potential Purchaser from award of such contract. If the State Treasurer or his designees determines that any contribution or action constitutes a breach of contract that poses a conflict of interest, pursuant to Chapter 51 and EO 117, the State Treasurer shall disqualify the Potential Purchaser from award of such contract.

**Please refer to ATTACHMENT #2 for copies of the Chapter 51/Executive Order 117 Vendor Certification and Disclosure of Political Contributions form and instructions. Failure to submit the attached Chapter 51/Executive Order 117 Vendor Certification and Disclosure of Political Contributions form shall be cause for rejection of your firm's offer.** The Potential Purchaser selected to provide services to the Authority shall maintain compliance with Chapter 51, EO 117 and EO 7 during the term of their engagement.

## **8.2 Ownership Disclosure**

The Ownership Disclosure addresses the requirements of N.J.S.A. 52:25-24.2, and for any contract it must be completed and submitted with the offer. The contract is not completed unless and until the Ownership Disclosure is properly completed and accepted. The form can be downloaded from the Department of the Treasury website under the heading Vendor Forms: <http://www.state.nj.us/treasury/purchase/forms.htm#eo134>. A copy of the Ownership Disclosure Form is attached hereto as ATTACHMENT #2

### **8.3 Affirmative Action Supplement with Affirmative Action Employee Information Report**

Affirmative Action Supplement with Affirmative Action Employee Information Report addresses the requirements of N.J.S.A. 10:5-31 to -34 and N.J.A.C. 17:27.3.1 et seq., and for any contract must be completed and submitted with the offer. The contract is not completed unless and until the form is properly completed and accepted. The forms can be downloaded from the Department of the Treasury website under the heading Vendor Forms:

<http://www.state.nj.us/treasury/purchase/forms.htm#eo134>.

A copy of the Affirmative Action Supplement with Affirmative Action Employee Information Report is attached hereto as ATTACHMENT #2.

### **8.4 Prevailing Wage Requirement**

Potential Purchaser shall comply with the Prevailing Wage requirements set forth in N.J.S.A. 52:27I-31 (P.L. 2010, c. 51).

### **8.5 Certification of Non-Involvement in Prohibited Activities in Iran**

Pursuant to N.J.S.A. 52:32-58, all Proposals submitted in response to this RFOTP must include the Potential Purchaser's certification that neither the Potential Purchaser, nor one of its parents, subsidiaries, and/or affiliates (as defined in N.J.S.A. 52:32-56(e)(3)), is listed on the State of New Jersey Department of the Treasury's List of Persons or Entities Engaging in Prohibited Investment Activities in Iran and that neither is involved in any of the investment activities set forth in N.J.S.A. 52:32-56(f). If the Potential Purchaser is unable to so certify, the Potential Purchaser shall provide a detailed and precise description of such activities. A copy of the Disclosure of Investment Activities in Iran form included in ATTACHMENT #2 must be completed and submitted by each Potential Purchaser with its Proposal.

### **8.6 Standards Prohibiting Conflicts of Interest**

The following prohibitions shall apply to all contracts made with the Authority.

(a) No Potential Purchaser shall pay, offer to pay, or agree to pay, either directly or indirectly, any fee, commission, compensation, gift, gratuity or other thing of value of any kind to any Board member, officer or employee of the State or the Authority, or special State officer or employee as defined in N.J.S.A. 52:13D-13b and e, or to any member of the immediate family, as defined by N.J.S.A. 52:13D-13f of any such Board member, officer or employee, or partnership, firm or corporation with which they are employed or associated or in which such officer or employee has an interest within the meaning of N.J.S.A. 52:13D-13g.

(b) The solicitation of any fee, commission, compensation, gift, gratuity or other thing of value by a Board member, officer or employee of the Authority from any Potential Purchaser shall be reported in writing forthwith by the Potential Purchaser to the State Attorney General.

(c) No Potential Purchaser may, directly or indirectly, undertake any private business, commercial or entrepreneurial relationship with, whether or not pursuant to employment, contract or other agreement express or implied, or sell any interest in such Potential Purchaser to any Board member, officer or employee of the Authority or special State officer or employee, or having any duties or responsibilities in connection with the purchase, acquisition or sale of any property or services by or to the Authority or with any person, firm or entity with which he is employed or associated or in which he has an interest within the meaning of N.J.S.A. 52:13D-13g.



- (d) No Potential Purchaser shall influence, or attempt to influence or cause to be influenced any Board member, officer or employee of the Authority in his official capacity in any manner which might tend to impair the objectivity or independence or judgment of said Board member, officer or employee.
- (e) No Potential Purchaser shall cause or influence, or attempt to cause or influence, any Board member, officer or employee of the Authority to use, or attempt to use, his official position to secure unwarranted privileges or advantages for the Potential Purchaser or any other person.
- (f) It is agreed and understood that the Authority reserves the right to determine whether a conflict of interest or the appearance of a conflict of interest exists which would under State law adversely affect or would be contrary to the best interest of the Authority.

## **8.7 Record Retention**

The selected Potential Purchaser shall maintain all documentation related to the purchase and development of the Property for a period of five (5) years from the date of completing the development of the Property. Such records shall be made available to the New Jersey Office of the State Comptroller upon request.

## **9.0 EVALUATION CRITERIA**

FMERA will evaluate each offer received in accordance with this RFOTP and shall identify the offer(s) determined to be responsive to all material elements set forth in the notice, including, but not limited to: purchase price; estimated permanent jobs to be created at or relocated to the parcel; purchase term including due diligence period and time needed to obtain approvals as well as payment for such period; proposed project capital investment; potential purchaser(s) financial capability to meet the proposed terms of purchase and project completion; impact to host municipality; and prior experience with the potential purchaser. Attachment #3 contains the proposed evaluation score sheet and weightings.

Potential purchaser should be prepared to commit to their job creation estimate in the Purchase and Sale Agreement & Redevelopment Agreement (PSARA). FMERA is looking to accelerate redevelopment of the Property to the extent possible. FMERA shall be under no obligation whatsoever, legal or otherwise, to sell or convey the Property or any interest in the Property unless and until a PSARA is fully negotiated with a Potential Purchaser and approved for execution by the FMERA Board of Members in its sole and absolute discretion. No Potential Purchaser or other party shall have any legal right or interest in the Property unless and until a PSARA is properly executed and delivered by FMERA.

**ATTACHMENT #1**  
**Description of Property**

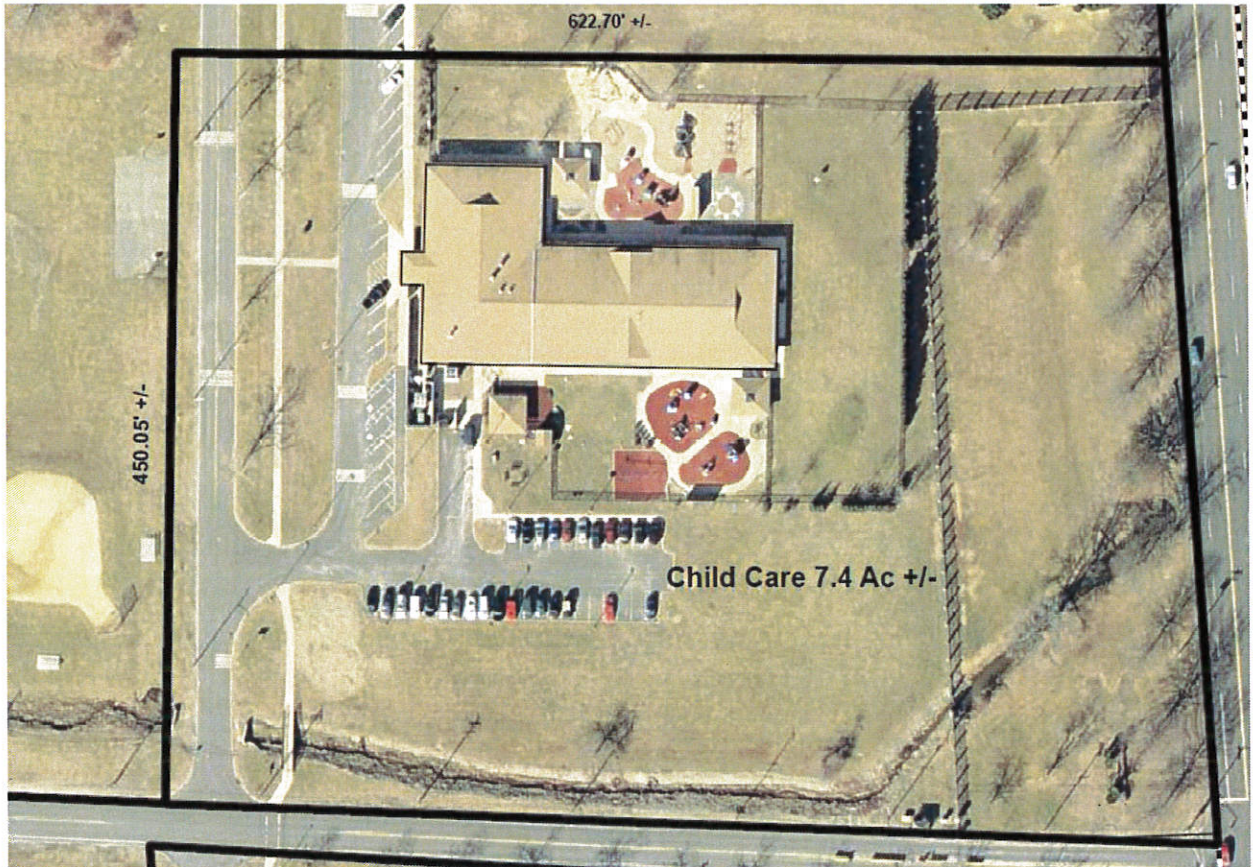

# Building 2290 Floor Plan:

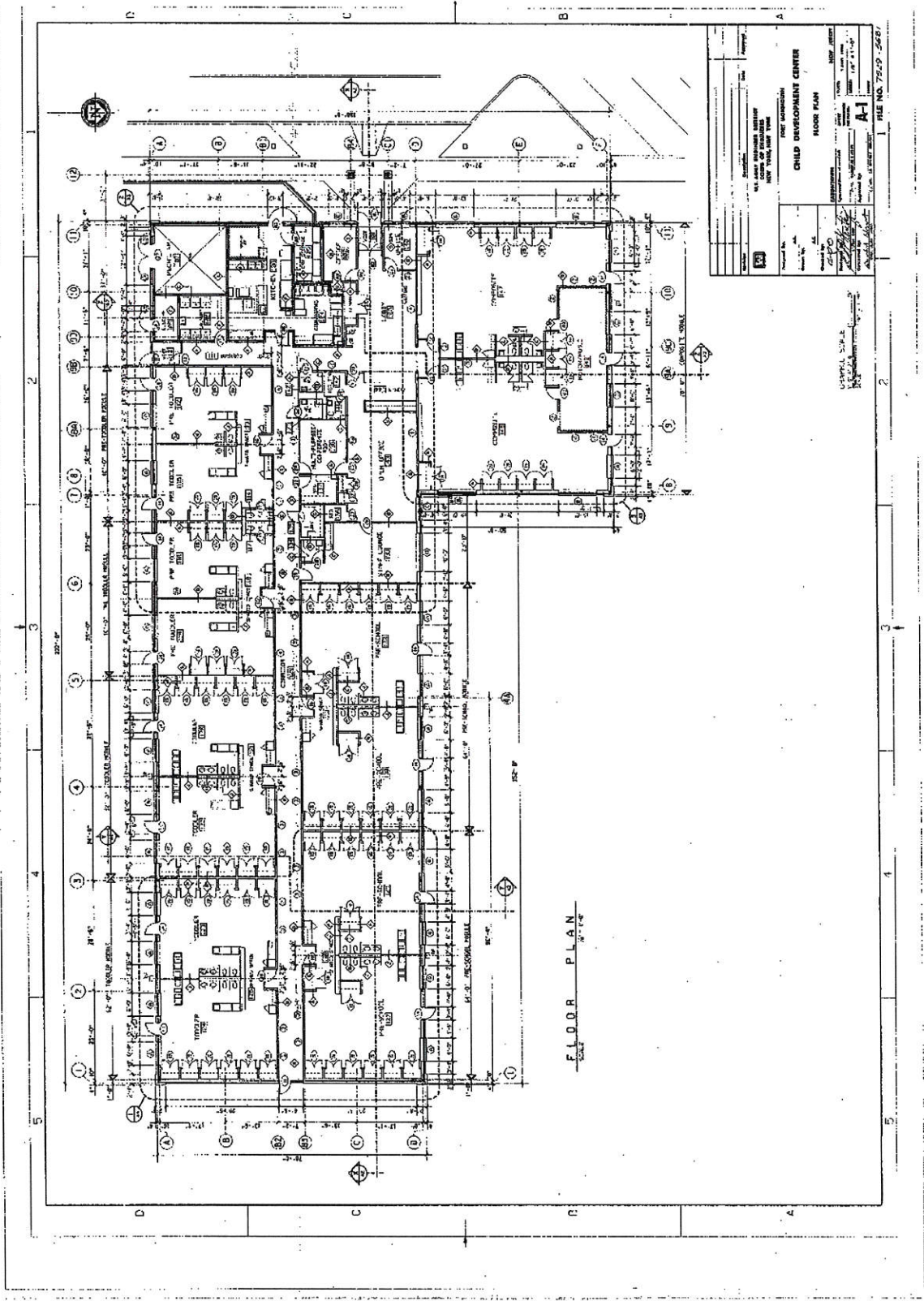

**ATTACHMENT #2  
REQUIRED FORMS**



**State of New Jersey**  
**Division of Purchase and Property**  
**Two-Year Chapter 51 / Executive Order 117 Vendor Certification and**  
**Disclosure of Political Contributions**

**For AGENCY USE ONLY**

**General Information**

Solicitation, RFP or Contract No. \_\_\_\_\_ Award Amount \_\_\_\_\_

Description of Services \_\_\_\_\_

**Agency Contact Information**

Agency \_\_\_\_\_ Contact Person \_\_\_\_\_

Phone Number \_\_\_\_\_ Agency Email \_\_\_\_\_

**Part 1: Vendor Information**

Full Legal Business Name \_\_\_\_\_  
 (Including trade name if applicable)

**Business Type**     Corporation     Limited Partnership     Professional Corporation     General Partnership  
 Limited Liability Company     Sole Proprietorship     Limited Liability Partnership

Address 1 \_\_\_\_\_ Address 2 \_\_\_\_\_

City \_\_\_\_\_ State \_\_\_\_\_ Zip \_\_\_\_\_ Phone \_\_\_\_\_

Vendor Email \_\_\_\_\_ Vendor FEIN \_\_\_\_\_

**Part 2: Public Law 2005, Chapter 51/ Executive Order 117 (2008) Certification**

I hereby certify as follows:

1. On or after October 15, 2004, neither the below-named entity nor any individual whose contributions are attributable to the entity pursuant to Executive Order 117 (2008) has solicited or made any contribution of money, pledge of contribution, including in-kind contributions, company or organization contributions, as set forth below that would bar the award of a contract to the vendor, pursuant to the terms of Executive Order 117 (2008).
  - a) **Within the preceding 18 months**, the below-named person or organization has not made a contribution to:
    - (i) Any candidate committee and/or election fund of any candidate for or holder of the public office of Governor or **Lieutenant Governor**,
    - (ii) Any State, county, **municipal** political party committee; OR
    - (iii) Any **legislative leadership committee**.
  - b) **During the term of office of the current Governor(s)**, the below-named person or organization has not made a contribution to
    - (i) Any candidate, committee and/or election fund of the Governor or **Lieutenant Governor**, OR
    - (ii) Any State, county or **municipal** political party committee nominating such Governor in the election preceding the commencement of said Governor's term.
  - c) **Within the 18 months immediately prior to the first day of the term of office of the Governor(s)**, the below-named person or organization has not made a contribution to
    - (i) Any candidate, committee and/or election fund of the Governor or **Lieutenant Governor**, OR  
 Any State, county, **municipal** political party committee of the political party nominating the successful gubernatorial candidate(s) in the last gubernatorial election.

**PLEASE NOTE:** Prior to November 15, 2008, the only disqualifying contributions include those made by the vendor or a principal owning or controlling more than 10 percent of the profits or assets of a business entity (or 10 percent of the stock in the case of a business entity that is a corporation for profit) to any candidate committee and/or election fund of the Governor or to any state or county political party within the preceding 18 months, during the term of office of the current Governor or within the 18 months immediately prior to the first day of the term of Office of Governor.

**Part 3: Disclosure of Contributions Made**

Check this box if no reportable contributions have been made by the above-named business entity or individual.

Name of Recipient \_\_\_\_\_ Address of Recipient \_\_\_\_\_

Date of Contribution \_\_\_\_\_ Amount of Contribution \_\_\_\_\_

Type of Contribution (i.e. currency, check, loan, in-kind \_\_\_\_\_

Contributor Name \_\_\_\_\_

Relationship of Contributor to the Vendor \_\_\_\_\_

Contributor Address \_\_\_\_\_

City \_\_\_\_\_ State \_\_\_\_\_ Zip \_\_\_\_\_

If this form is not being completed electronically, please attach pages for additional contributions as necessary. Otherwise click "Add a Contribution" to enter additional contributions.

**Part 4: Certification**

I have read the instructions accompanying this form prior to completing this certification on behalf of the above-named business entity. I certify that, to the best of my knowledge and belief, the foregoing statements by me are true. I am aware that if any of the statements are willfully false, I am subject to punishment.

**I understand that this certification will be in effect for two (2) years from the date of approval, provided the ownership status does not change and/or additional contributions are not made.** If there are any changes in the ownership of the entity or additional contributions are made, a new full set of documents are required to be completed and submitted. By submitting this Certification and Disclosure, the person or entity named herein acknowledges this continuing reporting responsibility and certifies that it will adhere to it.

(CHECK ONE BOX A, B or C)

- (A)  I am certifying on behalf of the above-named business entity and all individuals and/or entities whose contributions are attributable to the entity pursuant to Executive Order 117 (2008).
  
- (B)  I am certifying on behalf of the above-named business entity only.
  
- (C)  I am certifying on behalf of an individual and/or entity whose contributions are attributable to the vendor.

Signed Name \_\_\_\_\_ Print Name \_\_\_\_\_  
Phone Number \_\_\_\_\_ Date \_\_\_\_\_  
Title/Position \_\_\_\_\_

**Agency Submission of Forms**

The agency should submit the completed and signed Two-Year Vendor Certification and Disclosure forms, together with a completed Ownership Disclosure form, either electronically to [cd134@treas.state.nj.us](mailto:cd134@treas.state.nj.us), or regular mail at Chapter 51 Review Unit, P.O. Box 039, 33 West State Street, 9<sup>th</sup> Floor, Trenton, NJ 08625. The agency should save the forms locally and keep the original forms on file, and submit copies to the Chapter 51 Review Unit.

**INFORMATION AND INSTRUCTIONS**  
**For Completing The "Two- Year Vendor Certification and Disclosure of Political Contributions" Forms**

**Background Information**

On September 22, 2004, then-Governor James E. McGreevey issued Executive Order 134, the purpose of which was to insulate the negotiation and award of State contracts from political contributions that posed a risk of improper influence, purchase of access or the appearance thereof. To this end, Executive Order 134 prohibited State departments, agencies and authorities from entering into contracts exceeding \$17,500 with individuals or entities that made certain political contributions. Executive Order 134 was superseded by Public Law 2005, c. 51, signed into law on March 22, 2005 ("Chapter 51").

On September 24, 2008, Governor Jon S. Corzine issued Executive Order No. 117 ("E.O. 117"), which is designed to enhance New Jersey's efforts to protect the integrity of procurement decisions and increase the public's confidence in government. The Executive Order builds upon the provisions of Chapter 51.

**Two-Year Certification Process**

Upon approval by the State, the Certification and Disclosure of Political Contributions form (CH51.1R1/21/2009) is valid for a two (2) year period. Thus, if a vendor receives approval on Jan 1, 2009, the certification expiration date would be Dec 31, 2011. Any change in the vendor's ownership status and/or political contributions during the two-year period will require the submission of new Chapter 51/EO117 forms to the State Review Unit. **Please note that it is the vendor's responsibility to file new forms with the State should these changes occur.**

Prior to the awarding of a contract, the agency should first send an e-mail to [CD134@treas.state.nj.us](mailto:CD134@treas.state.nj.us) to verify the certification status of the vendor. If the response is that the vendor is NOT within an approved two-year period, then forms must be obtained from the vendor and forwarded for review. If the response is that the vendor is within an approved two-year period, then the response so stating should be placed with the bid/contract documentation for the subject project.

**Instructions for Completing the Forms**

**NOTE:** Please refer to the next section, "Useful Definitions for Purposes of Ch. 51 and E.O. 117," for guidance when completing the forms.

**Part 1: VENDOR INFORMATION**

**Business Name** – Enter the full name of the Vendor, including trade name if applicable.

**Business Type** -- Select the vendor's business organization from the list provided.

**Address, City, State, Zip and Phone Number** -- Enter the vendor's street address, city, state, zip code and telephone number.

**Vendor Email** – Enter the vendor's primary email address.

**Vendor FEIN** – Please enter the vendor's Federal Employment Identification Number.



**INFORMATION AND INSTRUCTIONS**  
**For Completing The "Two- Year Vendor Certification and Disclosure of Political Contributions" Forms**

**Part 2: PUBLIC LAW 2005, Chapter 51 / EXECUTIVE ORDER 117 (2008) DUAL CERTIFICATION**

Read the following statements and verify that from the period beginning on or after October 15, 2004, no contributions as set forth at subsections 1(a)-(c) have been made by either the vendor or any individual whose contributions are attributable to the vendor pursuant to Executive Order 117 (2008).

**NOTE:** Contributions made prior to November 15, 2008 are applicable to Chapter 51 only.

**Part 3: DISCLOSURE OF CONTRIBUTIONS MADE**

**Check the box at top of page 2 if no reportable contributions have been made by the vendor.** If the vendor has no contributions to report, this box must be checked.

**Name of Recipient Entity** – Enter the full name of the recipient entity.

**Address of Recipient Entity** – Enter the recipient entity's street address.

**Date of Contribution** – Indicate the date of the contribution.

**Amount of Contribution** – Enter the amount of the reportable contribution.

**Type of Contribution** – Select the type of contribution from the list provided.

**Contributor Name** – Enter the full name of the contributor.

**Relationship of Contributor to the Vendor** -- Indicate relationship of the contributor to the vendor, e.g. officer or partner of the company, spouse of officer or partner, resident child of officer or partner, parent company of the vendor, subsidiary of the vendor, etc.

**NOTE:** If form is being completed electronically, click "Add a Contribution" to enter additional contributions. Otherwise, please attach additional pages as necessary.

**Part 4: CERTIFICATION**

Check box A if the person completing the certification and disclosure is doing so on behalf of the vendor and all individuals and/or entities whose contributions are attributable to the vendor.

Check box B if the person completing the certification and disclosure is doing so on behalf of the vendor only.

Check box C if the person completing the certification and disclosure is doing so on behalf of an individual and/or entity whose contributions are attributable to the vendor.

Enter the full name of the person authorized to complete the certification and disclosure, the person's title or position, date and telephone number.

## INFORMATION AND INSTRUCTIONS For Completing The “Two- Year Vendor Certification and Disclosure of Political Contributions” Forms

### USEFUL DEFINITIONS FOR THE PURPOSES OF Ch. 51 and E.O. 117

- “Vendor” means the contracting entity.
- “Business Entity” means any natural or legal person, business corporation, professional services corporation, limited liability company, partnership, limited partnership, business trust, association or any other legal commercial entity organized under the laws of New Jersey or any other state or foreign jurisdiction. The definition also includes (i) if a business entity is a for-profit corporation, any officer of the corporation and any other person or business entity that owns or controls 10% or more of the stock of the corporation; (ii) if a business entity is a professional corporation, any shareholder or officer; (iii) if a business entity is a general partnership, limited partnership or limited liability partnership, any partner; (iv) if a business entity is a sole proprietorship, the proprietor; (v) if the business entity is any other form of entity organized under the laws of New Jersey or any other state or foreign jurisdiction, any principal, officer or partner thereof; (vi) any subsidiaries directly or indirectly controlled by the business entity; (vii) any political organization organized under 26 U.S.C.A. § 527 that is directly or indirectly controlled by the business entity, other than a candidate committee, election fund, or political party committee; and (viii) with respect to an individual who is included within the definition of “business entity,” that individual’s spouse or civil union partner and any child residing with that person.<sup>1</sup>
- “Officer” means a president, vice-president with senior management responsibility, secretary, treasurer, chief executive officer, or chief financial officer of a corporation or any person routinely performing such functions for a corporation. Please note that officers of non-profit entities are excluded from this definition.
- “Partner” means one of two or more natural persons or other entities, including a corporation, who or which are joint owners of and carry on a business for profit, and which business is organized under the laws of this State or any other state or foreign jurisdiction, as a general partnership, limited partnership, limited liability partnership, limited liability company, limited partnership association, or other such form of business organization.
- “Reportable Contributions” are those contributions, including in-kind contributions, in excess of \$300.00 in the aggregate per election made to or received by a candidate committee, joint candidates committee, or political committee; or per calendar year made to or received by a political party committee, legislative leadership committee, or continuing political committee.
- “In-kind Contribution” means a contribution of goods or services received by a candidate committee, joint candidates committee, political committee, continuing political committee, political party committee, or legislative leadership committee, which contribution is paid for by a person or entity other than the recipient committee, but does not include services provided without compensation by an individual volunteering a part of or all of his or her time on behalf of a candidate or committee.
- “Continuing Political Committee” includes any group of two or more persons acting jointly, or any corporation, partnership, or any other incorporated or unincorporated association, including a political club, political action committee, civic association or other organization, which in any calendar year contributes or expects to contribute at least \$4,300 to aid or promote the candidacy of an individual, or the candidacies of individuals, for elective public office, or the passage or defeat of a public questions, and which may be expected to make contributions toward such aid or promotion or passage or defeat during a subsequent election, provided that the group, corporation, partnership, association or other organization has been determined by the Commission to be a continuing political committee in accordance with N.J.S.A. 19:44A-8(b).

<sup>1</sup> Contributions made by a spouse, civil union partner or resident child to a candidate for whom the contributor is eligible to vote or to a political party committee within whose jurisdiction the contributor resides are permitted.

## INFORMATION AND INSTRUCTIONS For Completing The "Two- Year Vendor Certification and Disclosure of Political Contributions" Forms

- "Candidate Committee" means a committee established by a candidate pursuant to N.J.S.A. 19:44A-9(a), for the purpose of receiving contributions and making expenditures.
- "State Political Party Committee" means a committee organized pursuant to N.J.S.A. 19:5-4.
- "County Political Party Committee" means a committee organized pursuant to N.J.S.A. 19:5-3.
- "Municipal Political Party Committee" means a committee organized pursuant to N.J.S.A. 19:5-2.
- "Legislative Leadership Committee" means a committee established, authorized to be established, or designated by the President of the Senate, the Minority Leader of the Senate, the Speaker of the General Assembly, or the Minority Leader of the General Assembly pursuant to N.J.S.A. 19:44A-10.1 for the purpose of receiving contributions and making expenditures.
- "Political Party Committee" means:
  1. The State committee of a political party, as organized pursuant to N.J.S.A. 19:5-4;
  2. Any county committee of a political party, as organized pursuant to N.J.S.A. 19:5-3; or
  3. Any municipal committee of a political party, as organized pursuant to N.J.S.A. 19:5-2.

### Agency Submission of Forms

The agency should submit the completed and signed Two-Year Vendor Certification and Disclosure forms, together with a completed Ownership Disclosure form, either electronically to [cd134@treas.state.nj.us](mailto:cd134@treas.state.nj.us) or regular mail at Chapter 51 Review Unit, P.O. Box 039, 33 West State Street, 9<sup>th</sup> Floor, Trenton, NJ 08625. Original forms should remain with the Agency and copies should be sent to the Chapter 51 Review Unit.

### Questions & Answers

Questions regarding the interpretation or application of Public Law 2005, Chapter 51 (N.J.S.A. 19:44A-20.13) or Executive Order 117 (2008) may be submitted electronically through the Division of Purchase and Property website at <http://www.state.nj.us/treasury/purchase/execorder134.shtml>. Responses to previous questions are posted on the website, as well as additional reference materials and forms.

**NOTE:** The Chapter 51 Q&A on the website **DOES NOT** address the expanded pay-to-play requirements imposed by Executive Order 117. The Chapter 51 Q&A are only applicable to contributions made prior to November 15, 2008. There is a separate, combined Chapter 51/E.O. 117 Q&A section dealing specifically with issues pertaining to contributions made after November 15, 2008, available at <http://www.state.nj.us/treasury/purchase/execorder134.shtml#state>.

**STATE OF NEW JERSEY -- DIVISION OF PURCHASE AND PROPERTY  
OWNERSHIP DISCLOSURE FORM**

Solicitation Number: \_\_\_\_\_ Bidder/Offeror: \_\_\_\_\_

**PART 1: PLEASE COMPLETE THE QUESTIONS BELOW BY CHECKING EITHER THE "YES" OR "NO" BOX.**

**ALL PARTIES ENTERING INTO A CONTRACT WITH THE STATE ARE REQUIRED TO COMPLETE THIS FORM PURSUANT TO N.J.S.A. 52:25-24.2**

**PLEASE NOTE: IF THE BIDDER/OFFEROR IS A NON-PROFIT, THIS FORM IS NOT REQUIRED. PLEASE COMPLETE THE SEPARATE DISCLOSURE OF INVESTIGATIONS FORM.**

- |   |                          |                          |
|---|--------------------------|--------------------------|
|   | <b>YES</b>               | <b>NO</b>                |
| 1. Are there any individuals, corporations or partnerships owning a <b>10% or greater</b> interest in the bidder/offeror? | <input type="checkbox"/> | <input type="checkbox"/> |

IF THE ANSWER TO QUESTION 1 IS **NO**, PLEASE SIGN AND DATE THE FORM. YOU DO NOT HAVE TO COMPLETE ANY MORE QUESTIONS ON THIS FORM. IF THE ANSWER TO QUESTION 1 IS **YES**, PLEASE ANSWER QUESTIONS 2-4 BELOW.

- |   |                          |                          |
|---|--------------------------|--------------------------|
| 2. Of those parties owning a 10% or greater interest in the bidder/offeror, are any of those parties <b>individuals</b> ?   | <input type="checkbox"/> | <input type="checkbox"/> |
| 3. Of those parties owning a 10% or greater interest in the bidder/offeror, are any of those parties <b>corporations or partnerships</b> ?                          | <input type="checkbox"/> | <input type="checkbox"/> |
| 4. If your answer to Question 3 is "YES", are there any parties owning a <b>10% or greater</b> interest in the corporation or partnership referenced in Question 3? | <input type="checkbox"/> | <input type="checkbox"/> |

IF **ANY** OF THE ANSWERS TO QUESTIONS 2-4 ARE **YES**, PLEASE PROVIDE THE REQUESTED INFORMATION IN PART 2 BELOW.

**PART 2: PLEASE PROVIDE FURTHER INFORMATION RELATED TO QUESTIONS 2-4 ANSWERED AS "YES".**

For Questions 2-4 answered "YES", you **must** disclose identifying information related to the individuals, partnerships and/or corporations owning a 10% or greater interest in the bidder/offeror. Further, if one or more of these entities is itself a corporation or partnership, you must also disclose all parties that own a 10% or greater interest in that corporation or partnership. This information is required by statute.

**TO COMPLETE PART 2, PLEASE PROVIDE THE REQUESTED INFORMATION PERTAINING TO EITHER **INDIVIDUALS** OR **PARTNERSHIPS/CORPORATIONS** HAVING A 10% OR GREATER INTEREST IN THE BIDDER/OFFEROR. IF YOU NEED TO MAKE ADDITIONAL ENTRIES, CLICK THE "ADD AN ENTRY" BUTTON IN THE APPROPRIATE ENTITY TYPE.**

<b>Individuals</b>	
<p>Name: _____ Date of Birth: _____</p> <p>Home Address: _____</p> <p>City _____ State _____ Zip Code _____</p> <p align="center">Are there <b>additional</b> entities holding <b>10% or greater</b> ownership interest in the bidder/offeror and its parent corporation/partnership?</p> <p align="center"><input type="checkbox"/> Yes or <input type="checkbox"/> No</p>	<div style="border: 1px solid black; padding: 5px; width: 80px; margin: auto;">Delete Entry</div>
<div style="border: 1px solid black; padding: 5px; width: 250px; margin: auto;">Add An Additional Individuals Entry</div>	

**Partnerships/Corporations**

Entity Name: \_\_\_\_\_

Partner Name: \_\_\_\_\_

Business Address: \_\_\_\_\_

City \_\_\_\_\_ State \_\_\_\_\_ Zip Code \_\_\_\_\_

Delete Entry

Are there **additional** entities holding **10% or greater** ownership interest in the bidder/offeror and its parent corporation/partnership?

Yes    or     No

Add An Additional Partnerships/Corporations Entry

Certification: I, being duly sworn upon my oath, hereby represent that the foregoing information and any attachments thereto to the best of my knowledge are true and complete. I acknowledge: that I am authorized to execute this certification on behalf of the bidder; that the State of New Jersey is relying on the information contained herein and that I am under a continuing obligation from the date of this certification through the completion of any contracts with the State to notify the State in writing of any changes to the information contained herein; that I am aware that it is a criminal offense to make a false statement or misrepresentation in this certification, and if I do so, I am subject to criminal prosecution under the law and that it will constitute a material breach of my agreement(s) with the State, permitting the State to declare any contract(s) resulting from this certification void and unenforceable.

Full Name (Print): \_\_\_\_\_ Signature: \_\_\_\_\_

Title: \_\_\_\_\_ Date: \_\_\_\_\_

FEIN/SSN: \_\_\_\_\_

**STATE OF NEW JERSEY -- DIVISION OF PURCHASE AND PROPERTY  
DISCLOSURE OF INVESTIGATIONS AND OTHER ACTIONS INVOLVING BIDDER FORM**

Solicitation Number: \_\_\_\_\_ Bidder/Offeror: \_\_\_\_\_

**PART 1: PLEASE COMPLETE THE QUESTIONS BELOW BY CHECKING EITHER THE "YES" OR "NO" BOX.**  
PLEASE REFER TO THE PERSONS AND/OR ENTITIES LISTED ON YOUR OWNERSHIP DISCLOSURE FORM WHEN ANSWERING THE QUESTIONS BELOW.

**NON-PROFIT ENTITIES:** PLEASE LIST **ALL** OFFICERS/DIRECTORS IN **PART 2** OF THIS FORM. YOU WILL BE REQUIRED TO ANSWER THE QUESTIONS BELOW WITH RESPECT TO THESE INDIVIDUALS.

- |   | YES                      | NO                       |
|---|--------------------------|--------------------------|
| 1. Has any person or entity listed on this form or its attachments ever been arrested, charged, indicted, or convicted in a criminal or disorderly persons matter by the State of New Jersey (or political subdivision thereof), any other state or the U.S. Government?                                  | <input type="checkbox"/> | <input type="checkbox"/> |
| 2. Has any person or entity listed on this form or its attachments ever been suspended, debarred or otherwise declared ineligible by any government agency from bidding or contracting to provide services, labor, materials or supplies?   | <input type="checkbox"/> | <input type="checkbox"/> |
| 3. Are there currently any pending criminal matters or debarment proceedings in which the firm and/or its officers and/or managers are involved?  | <input type="checkbox"/> | <input type="checkbox"/> |
| 4. Has any person or entity listed on this form or its attachments been denied any license, permit or similar authorization required to engage in the work applied for herein, or has any such license, permit or similar authorization been revoked by any agency of federal, state or local government? | <input type="checkbox"/> | <input type="checkbox"/> |

IF **ANY** OF THE ANSWERS TO QUESTIONS 1-4 ARE **YES**, PLEASE PROVIDE THE REQUESTED INFORMATION IN PART 2 BELOW.  
IF **ALL** OF THE ANSWERS TO QUESTIONS 1-4 ARE **NO**, PLEASE READ AND SIGN THE FORM BELOW. NO FURTHER ACTION IS NEEDED.  
IF YOU ARE A NON-PROFIT, YOU MUST DISCLOSE ALL OFFICERS/DIRECTORS IN PART 2 BELOW.

**PART 2: PROVIDING ADDITIONAL INFORMATION**

For Questions 1-4 answered "YES", you **must** provide a detailed description of any investigation or litigation, including but not limited to administrative complaints or other administrative proceedings, involving public sector clients during the past 5 years. This description must include the nature and status of the investigation, and for any litigation, the caption of the action, a brief description of the action, the date of inception, current status, and if applicable, disposition. Please provide this information in the box labeled 'Additional Information' below. The box will prompt you to provide the information referenced above. Please provide thorough answers to each question. Click on the "Add Additional Information" button below the box if you need to make additional entries.

**Non-profit bidder/offerors** must disclose the individuals serving as officers or directors for purposes of this form. Please indicate all individuals acting in either capacity by providing the information located in the 'Officers/Directors' box. If additional entries are needed, click the "Add an Officer/Director Entry" button.

**Once all required information has been disclosed, complete the certification beneath the "Additional Information" section below. Failure to complete this form may render your proposal non-responsive.**

### Additional Information

Person or Entity \_\_\_\_\_ Date of Inception: \_\_\_\_\_

Current Status \_\_\_\_\_

Brief Description \_\_\_\_\_

Caption of Action (if applicable) \_\_\_\_\_ Disposition of Action (if applicable) \_\_\_\_\_

Delete Entry

Bidder/Offeror Contact Name \_\_\_\_\_

Contact Phone Number \_\_\_\_\_

Add Additional Information

### Officers/Directors

Name: \_\_\_\_\_

Title \_\_\_\_\_ DOB \_\_\_\_\_

Address \_\_\_\_\_

City \_\_\_\_\_ State \_\_\_\_\_ Zip Code \_\_\_\_\_

Phone \_\_\_\_\_ E-Mail \_\_\_\_\_

Delete Entry

Add An Additional Officer/Director Entry

Certification: I, being duly sworn upon my oath, hereby represent that the foregoing information and any attachments thereto to the best of my knowledge are true and complete. I acknowledge: that I am authorized to execute this certification on behalf of the bidder; that the State of New Jersey is relying on the information contained herein and that I am under a continuing obligation from the date of this certification through the completion of any contracts with the State to notify the State in writing of any changes to the information contained herein; that I am aware that it is a criminal offense to make a false statement or misrepresentation in this certification, and if I do so, I am subject to criminal prosecution under the law and that it will constitute a material breach of my agreement(s) with the State, permitting the State to declare any contract (s) resulting from this certification void and unenforceable.

Full Name (Print): \_\_\_\_\_ Signature: \_\_\_\_\_

Title: \_\_\_\_\_ Date: \_\_\_\_\_

**STATE OF NEW JERSEY -- DIVISION OF PURCHASE AND PROPERTY  
DISCLOSURE OF INVESTMENT ACTIVITIES IN IRAN**

Quote Number: \_\_\_\_\_

Bidder/Offeror: \_\_\_\_\_

**PART 1: CERTIFICATION**

**BIDDERS MUST COMPLETE PART 1 BY CHECKING EITHER BOX.**

**FAILURE TO CHECK ONE OF THE BOXES WILL RENDER THE PROPOSAL NON-RESPONSIVE.**

Pursuant to Public Law 2012, c. 25, any person or entity that submits a bid or proposal or otherwise proposes to enter into or renew a contract must complete the certification below to attest, under penalty of perjury, that neither the person or entity, nor any of its parents, subsidiaries, or affiliates, is identified on the Department of Treasury's Chapter 25 list as a person or entity engaging in investment activities in Iran. The Chapter 25 list is found on the Division's website at <http://www.state.nj.us/treasury/purchase/pdf/Chapter25List.pdf>. Bidders must review this list prior to completing the below certification. **Failure to complete the certification will render a bidder's proposal non-responsive.** If the Director finds a person or entity to be in violation of law, s/he shall take action as may be appropriate and provided by law, rule or contract, including but not limited to, imposing sanctions, seeking compliance, recovering damages, declaring the party in default and seeking debarment or suspension of the party

**PLEASE CHECK THE APPROPRIATE BOX:**

I certify, pursuant to Public Law 2012, c. 25, that neither the bidder listed above nor any of the bidder's parents, subsidiaries, or affiliates is listed on the N.J. Department of the Treasury's list of entities determined to be engaged in prohibited activities in Iran pursuant to P.L. 2012, c. 25 ("Chapter 25 List"). I further certify that I am the person listed above, or I am an officer or representative of the entity listed above and am authorized to make this certification on its behalf. **I will skip Part 2 and sign and complete the Certification below.**

**OR**

I am unable to certify as above because the bidder and/or one or more of its parents, subsidiaries, or affiliates is listed on the Department's Chapter 25 list. I will provide a detailed, accurate and precise description of the activities in Part 2 below and sign and complete the Certification below. Failure to provide such will result in the proposal being rendered as non-responsive and appropriate penalties, fines and/or sanctions will be assessed as provided by law.

**PART 2: PLEASE PROVIDE FURTHER INFORMATION RELATED TO INVESTMENT ACTIVITIES IN IRAN**

You must provide a detailed, accurate and precise description of the activities of the bidding person/entity, or one of its parents, subsidiaries or affiliates, engaging in the investment activities in Iran outlined above by completing the boxes below.

**EACH BOX WILL PROMPT YOU TO PROVIDE INFORMATION RELATIVE TO THE ABOVE QUESTIONS. PLEASE PROVIDE THOROUGH ANSWERS TO EACH QUESTION. IF YOU NEED TO MAKE ADDITIONAL ENTRIES, CLICK THE "ADD AN ADDITIONAL ACTIVITIES ENTRY" BUTTON.**

Name _____	Relationship to Bidder/Offeror _____
Description of Activities _____ _____	
Duration of Engagement _____	Anticipated Cessation Date _____
Bidder/Offeror Contact Name _____	Contact Phone Number _____

**ADD AN ADDITIONAL ACTIVITIES ENTRY**

Certification: I, being duly sworn upon my oath, hereby represent that the foregoing information and any attachments thereto to the best of my knowledge are true and complete. I acknowledge: that I am authorized to execute this certification on behalf of the bidder; that the State of New Jersey is relying on the information contained herein and that I am under a continuing obligation from the date of this certification through the completion of any contracts with the State to notify the State in writing of any changes to the information contained herein; that I am aware that it is a criminal offense to make a false statement or misrepresentation in this certification, and if I do so, I am subject to criminal prosecution under the law and that it will constitute a material breach of my agreement(s) with the State, permitting the State to declare any contract(s) resulting from this certification void and unenforceable.

Full Name (Print): \_\_\_\_\_

Signature: \_\_\_\_\_

Title: \_\_\_\_\_

Date: \_\_\_\_\_



**STATE OF NEW JERSEY**  
Division of Purchase & Property  
Contract Compliance Audit Unit  
EEO Monitoring Program

**EMPLOYEE INFORMATION REPORT**

**IMPORTANT-READ INSTRUCTIONS CAREFULLY BEFORE COMPLETING FORM. FAILURE TO PROPERLY COMPLETE THE ENTIRE FORM AND TO SUBMIT THE REQUIRED \$150.00 FEE MAY DELAY ISSUANCE OF YOUR CERTIFICATE. DO NOT SUBMIT EEO-1 REPORT FOR SECTION B, ITEM 11. For Instructions on completing the form, go to:**

**SECTION A - COMPANY IDENTIFICATION**

1. FID. NO. OR SOCIAL SECURITY	2. TYPE OF BUSINESS <input type="checkbox"/> 1. MFG <input type="checkbox"/> 2. SERVICE <input type="checkbox"/> 3. WHOLESALE <input type="checkbox"/> 4. RETAIL <input type="checkbox"/> 5. OTHER	3. TOTAL NO. EMPLOYEES IN THE ENTIRE COMPANY
4. COMPANY NAME		
5. STREET	CITY	COUNTY STATE ZIP CODE
6. NAME OF PARENT OR AFFILIATED COMPANY (IF NONE, SO INDICATE)		CITY STATE ZIP CODE
7. CHECK ONE: IS THE COMPANY: <input type="checkbox"/> SINGLE-ESTABLISHMENT EMPLOYER <input type="checkbox"/> MULTI-ESTABLISHMENT EMPLOYER		
8. IF MULTI-ESTABLISHMENT EMPLOYER STATE THE NUMBER OF ESTABLISHMENTS IN NJ		
9. TOTAL NUMBER OF EMPLOYEES AT ESTABLISHMENT WHICH HAS BEEN AWARDED THE CONTRACT		
10. PUBLIC AGENCY AWARDED CONTRACT		CITY COUNTY STATE ZIP CODE
<b>Official Use Only</b>	DATE RECEIVED	INAUG. DATE ASSIGNED CERTIFICATION NUMBER

**SECTION B - EMPLOYMENT DATA**

11. Report all permanent, temporary and part-time employees ON YOUR OWN PAYROLL. Enter the appropriate figures on all lines and in all columns. Where there are no employees in a particular category, enter a zero. Include ALL employees, not just those in minority/non-minority categories, in columns 1, 2, & 3. DO NOT SUBMIT AN EEO-1 REPORT.

JOB CATEGORIES	ALL EMPLOYEES			PERMANENT MINORITY/NON-MINORITY EMPLOYEE BREAKDOWN										
	COL. 1 TOTAL (Cols. 2 & 3)	COL. 2 MALE	COL. 3 FEMALE	***** MALE *****					***** FEMALE *****					
				BLACK	HISPANIC	AMER. INDIAN	ASIAN	NON MIN.	BLACK	HISPANIC	AMER. INDIAN	ASIAN	NON MIN.	
Officials/ Managers														
Professionals														
Technicians														
Sales Workers														
Office & Clerical														
Craftworkers (Skilled)														
Operatives (Semi-skilled)														
Laborers (Unskilled)														
Service Workers														
TOTAL														
Total employment From previous Report (if any)														
Temporary & Part-Time Employees	The data below shall NOT be included in the figures for the appropriate categories above.													

12. HOW WAS INFORMATION AS TO RACE OR ETHNIC GROUP IN SECTION B OBTAINED? <input type="checkbox"/> 1. Visual Survey <input type="checkbox"/> 2. Employment Record <input type="checkbox"/> 3. Other (Specify)	14. IS THIS THE FIRST Employee Information Report Submitted? 1. YES <input type="checkbox"/> 2. NO <input type="checkbox"/>	15. IF NO, DATE LAST REPORT SUBMITTED MO. DAY YEAR
13. DATES OF PAYROLL PERIOD USED From: _____ To: _____		

**SECTION C - SIGNATURE AND IDENTIFICATION**

16. NAME OF PERSON COMPLETING FORM (Print or Type)	SIGNATURE	TITLE	DATE MO   DAY   YEAR
17. ADDRESS NO. & STREET	CITY	COUNTY	STATE ZIP CODE PHONE (AREA CODE, NO., EXTENSION)

# INSTRUCTIONS FOR COMPLETING THE EMPLOYEE INFORMATION REPORT (FORM AA302)

**IMPORTANT:** READ THE FOLLOWING INSTRUCTIONS CAREFULLY BEFORE COMPLETING THE FORM. PRINT OR TYPE ALL INFORMATION. FAILURE TO PROPERLY COMPLETE THE ENTIRE FORM AND TO SUBMIT THE REQUIRED \$150.00 NON-REFUNDABLE FEE MAY DELAY ISSUANCE OF YOUR CERTIFICATE. IF YOU HAVE A CURRENT CERTIFICATE OF EMPLOYEE INFORMATION REPORT, DO NOT COMPLETE THIS FORM UNLESS YOU ARE RENEWING A CERTIFICATE THAT IS DUE FOR EXPIRATION. DO NOT COMPLETE THIS FORM FOR CONSTRUCTION CONTRACT AWARDS.

**ITEM 1** - Enter the Federal Identification Number assigned by the Internal Revenue Service, or if a Federal Employer Identification Number has been applied for, or if your business is such that you have not or will not receive a Federal Employer Identification Number, enter the Social Security Number of the owner or of one partner, in the case of a partnership.

**ITEM 2** - Check the box appropriate to your TYPE OF BUSINESS. If you are engaged in more than one type of business check the predominate one. If you are a manufacturer deriving more than 50% of your receipts from your own retail outlets, check "Retail".

**ITEM 3** - Enter the total "number" of employees in the entire company, including part-time employees. This number shall include all facilities in the entire firm or corporation.

**ITEM 4** - Enter the name by which the company is identified. If there is more than one company name, enter the predominate one.

**ITEM 5** - Enter the physical location of the company. Include City, County, State and Zip Code.

**ITEM 6** - Enter the name of any parent or affiliated company including the City, County, State and Zip Code. If there is none, so indicate by entering "None" or N/A.

**ITEM 7** - Check the box appropriate to your type of company establishment. "Single-establishment Employer" shall include an employer whose business is conducted at only one physical location. "Multi-establishment Employer" shall include an employer whose business is conducted at more than one location.

**ITEM 8** - If "Multi-establishment" was entered in item 8, enter the number of establishments within the State of New Jersey.

**ITEM 9** - Enter the total number of employees at the establishment being awarded the contract.

**ITEM 10** - Enter the name of the Public Agency awarding the contract. Include City, County, State and Zip Code. This is not applicable if you are renewing a current Certificate.

**ITEM 11** - Enter the appropriate figures on all lines and in all columns. THIS SHALL ONLY INCLUDE EMPLOYMENT DATA FROM THE FACILITY THAT IS BEING AWARDED THE CONTRACT. DO NOT list the same employee in more than one job category. **DO NOT attach an EEO-1 Report.**

**Racial/Ethnic Groups will be defined:**

**Black:** Not of Hispanic origin. Persons having origin in any of the Black racial groups of Africa.

**Hispanic:** Persons of Mexican, Puerto Rican, Cuban, or Central or South American or other Spanish culture or origin, regardless of race.

**American Indian or Alaskan Native:** Persons having origins in any of the original peoples of North America, and who maintain cultural identification through tribal affiliation or community recognition.

**Asian or Pacific Islander:** Persons having origin in any of the original peoples of the Far East, Southeast Asia, the Indian Sub-continent or the Pacific Islands. This area includes for example, China, Japan, Korea, the Phillipine Islands and Samoa.

**Non-Minority:** Any Persons not identified in any of the aforementioned Racial/Ethnic Groups.

**ITEM 12** - Check the appropriate box. If the race or ethnic group information was not obtained by 1 or 2, specify by what other means this was done in 3.

**ITEM 13** - Enter the dates of the payroll period used to prepare the employment data presented in Item 12.

**ITEM 14** - If this is the first time an Employee Information Report has been submitted for this company, check block "Yes".

**ITEM 15** - If the answer to Item 15 is "No", enter the date when the last Employee Information Report was submitted by this company.

**ITEM 16** - Print or type the name of the person completing the form. Include the signature, title and date.

**ITEM 17** - Enter the physical location where the form is being completed. Include City, State, Zip Code and Phone Number.

## TYPE OR PRINT IN SHARP BALL POINT PEN

THE VENDOR IS TO COMPLETE THE EMPLOYEE INFORMATION REPORT FORM (AA302) AND RETAIN A COPY FOR THE VENDOR'S OWN FILES. THE VENDOR SHOULD ALSO SUBMIT A COPY TO THE PUBLIC AGENCY AWARDED THE CONTRACT IF THIS IS YOUR FIRST REPORT; AND FORWARD ONE COPY WITH A CHECK IN THE AMOUNT OF \$150.00 PAYABLE TO THE TREASURER, STATE OF NEW JERSEY(FEE IS NON-REFUNDABLE) TO:

**NJ Department of the Treasury  
Division of Purchase & Property  
Contract Compliance Audit Unit  
EEO Monitoring Program**

P.O. Box 206

Trenton, New Jersey 08625-0206

Telephone No. (609) 292-5473

**ATTACHMENT #3  
EVALUATION SCORE SHEET**

**Fort Monmouth Economic Revitalization Authority (FMERA)  
Request for Proposals  
Fort Monmouth CDC/Building 2290 RFOTP**

Bidder: \_\_\_\_\_

Evaluator #: \_\_\_\_\_

<u>Sample Score Sheet</u>	<u>Score 0-10</u> x	<u>Weight</u> =	<u>Criterion</u> <u>Score</u>
1. Purchase price [weight = 50]		<b>50</b>	
2. Estimated permanent jobs to be created at or relocated to the parcel [weight = 20]		<b>20</b>	
3. Purchase term including due diligence period and time needed to obtain approvals as well as payment for such period [weight = 5]		<b>5</b>	
4. Proposed project capital investment [weight = 10]		<b>10</b>	
5. Potential Purchaser(s) financial capability to meet the proposed terms of purchase and project completion [weight = 5]		<b>5</b>	
6. Prior experience with the Potential Purchaser [weight = 5]		<b>5</b>	
7. Impact to host municipality [weight = 5]		<b>5</b>	
<b>Total Score</b>		<b>100</b>	